



## PRE-ENGINEERED COMPONENTS COARSE PITCH AXLE

**AT**  
 P: 0800 301 060  
 F: 0800 401 020  
[dme\\_oesterreich@milacron.com](mailto:dme_oesterreich@milacron.com)

**BE**  
 P: +32 (0) 15 28 87 30  
 F: +32 (0) 15 40 51 17  
[dme\\_benelux@milacron.com](mailto:dme_benelux@milacron.com)

**CH**  
 P: +41 0848 567 364  
 F: +41 0848 567 365  
[dme\\_schweiz@milacron.com](mailto:dme_schweiz@milacron.com)

**CZ**  
 P: 800 142 451 | +420 572 151 754  
 F: 800 142 450 | +420 571 611 996  
[dme\\_cz@milacron.com](mailto:dme_cz@milacron.com)

**DE**  
 P: 0800 664 82 50 | +49 (0) 2351 437 0  
 F: 0800 664 82 51 | +49 (0) 2351 437 220  
[dme\\_normalien@milacron.com](mailto:dme_normalien@milacron.com)

**ES**  
 P: 900 900 342  
 F: 900 900 343  
[dme\\_iberia@milacron.com](mailto:dme_iberia@milacron.com)

**FR**  
 P: +33 1 49 93 92 23  
 F: +33 1 49 93 92 22  
[dme\\_france@milacron.com](mailto:dme_france@milacron.com)

**HU**  
 P: 06 80 205003  
 F: +32 15 40 51 17  
[dme\\_hungary@milacron.com](mailto:dme_hungary@milacron.com)

**IT**  
 P: 800 089 734  
 F: 800 089 735  
[dme\\_italy@milacron.com](mailto:dme_italy@milacron.com)

**NL**  
 P: +31 (0) 20 654 5571  
 F: +31 (0) 20 654 5572  
[dme\\_benelux@milacron.com](mailto:dme_benelux@milacron.com)

**PL**  
 P: +800 331 1312 | +32 15 21 50 92  
 F: +800 331 1313 | +32 15 40 51 92  
[dme\\_polska@milacron.com](mailto:dme_polska@milacron.com)

**PT**  
 P: 800 207 900  
 F: 800 207 901  
[dme\\_iberia@milacron.com](mailto:dme_iberia@milacron.com)

**SK**  
 P: 0800 142 451 | +420 572 151 754  
 F: 0800 142 450 | +420 571 611 996  
[dme\\_cz@milacron.com](mailto:dme_cz@milacron.com)

**UK**  
 P: +44 2071 3300 37  
 F: +44 2071 3300 36  
[dme\\_uk@milacron.com](mailto:dme_uk@milacron.com)

**Other Countries**  
 P: +32 15 28 87 30  
 F: +32 15 40 51 17  
[dme\\_export@milacron.com](mailto:dme_export@milacron.com)

## WZ 1000

Coarse pitch axles

Mat.: W1.0715 max 570N/mm<sup>2</sup>

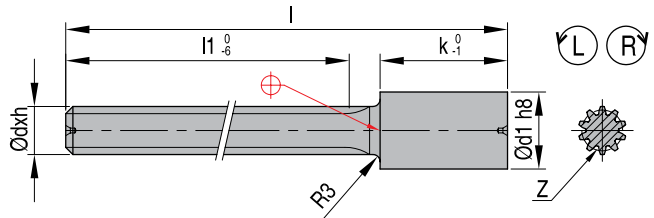

Specially designed coarse pitch axles and transmission components are also available!

REF	d	x	h	l1	d1 h8	l	k	z	REF	d	x	h	l1	d1 h8	l	k	z
Wz 1000	20	x	60	240	32	325	53	5	Wz 1000	38	x	120	350-6	48	475	93	10
Wz 1000	28	x	80	300-5	40	425	93	9	Wz 1000	38	x	120	450-6	48	575	93	10
Wz 1000	28	x	80	400-5	40	525	93	9	Wz 1000	38	x	160	350	48	475	93	11
Wz 1000	28	x	120	300	40	425	93	10	Wz 1000	38	x	160	450	48	575	93	11
Wz 1000	28	x	120	400	40	525	93	10	Wz 1000	38	x	200	350	48	475	93	12
Wz 1000	28	x	160	300	40	425	93	11	Wz 1000	38	x	200	450	48	575	93	12
Wz 1000	28	x	160	400	40	525	93	11									

## WZ 1010

Coarse pitch nuts

Mat.: Steel - special-Polyamide ≤ 80°C

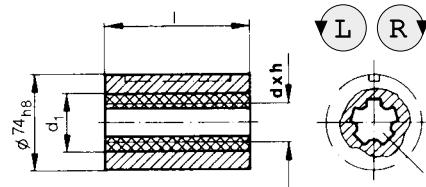
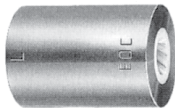

REF	d	x	h	l	d1	z	REF	d	x	h	l	d1	z
Wz 1010	28	x	80	100	40	9	Wz 1010	38	x	120	120	52	10
Wz 1010	28	x	120	100	40	10	Wz 1010	38	x	160	120	52	11
Wz 1010	28	x	160	100	40	11	Wz 1010	38	x	200	120	52	12

## WZ 1020

Coarse pitch nuts

Mat.: 2.0550 (CuZn 40 Al 2 D SoMs 58 Al 2)

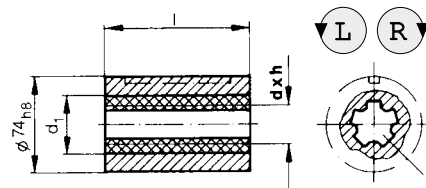

REF	d	x	h	l	d1h8	z	REF	d	x	h	l	d1h8	z
Wz 1020	20	x	60	60	45	5	Wz 1020	38	x	120	120	65	10
Wz 1020	28	x	80	100	55	9	Wz 1010	38	x	160	120	52	11
Wz 1020	28	x	120	100	55	10	Wz 1010	38	x	200	120	52	12

## WZ 1060

Woodruff keys

Mat.: 1.0503 (C 45) -DIN 6885

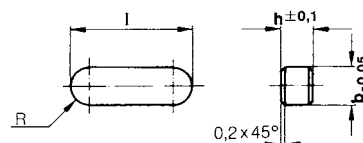

REF	b	h	l	REF	b	h	l	REF	b	h	l
Wz 1060 5 - 5 - 14				Wz 1060 8 - 5 - 40				Wz 1060 10 - 6 - 50			
Wz 1060 8 - 5 - 18				Wz 1060 10 - 6 - 40				Wz 1060 10 - 6 - 60			
Wz 1060 8 - 5 - 34				Wz 1060 10 - 6 - 45				Wz 1060 10 - 6 - 65			

# WZ 1100

Coarse pitch axles

Mat.: ~1.0727~980N/mm<sup>2</sup>

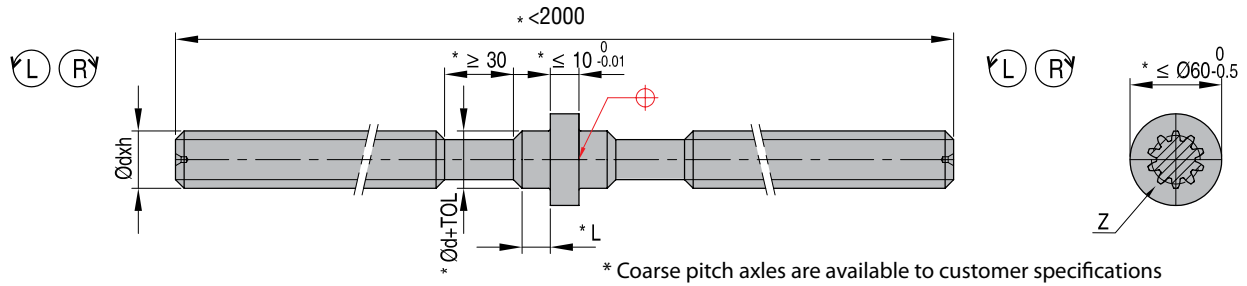

REF	d	h	z	REF	d	h	z
WZ 1100	28	80 LR	9	WZ 1100	38	120 LR	10
WZ 1100	28	80 RL	9	WZ 1100	38	120 RL	10
WZ 1100	28	120 LR	10	WZ 1100	38	160 LR	11
WZ 1100	28	120 RL	10	WZ 1100	38	160 RL	11
WZ 1100	28	160 LR	11	WZ 1100	38	200 LR	12
WZ 1100	28	160 RL	11	WZ 1100	38	200 RL	12

# WZ 1030

Pinion shafts

Mat.: ~1.2767~830N/mm<sup>2</sup>

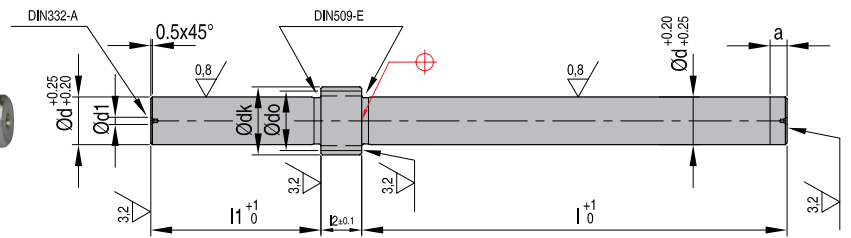

Specially designed coarse pitch axles and transmission components are also available!

REF	d	m	d0	dk	d1	l	l1	l2	a	z	REF	d	m	d0	dk	d1	l	l1	l2	a	z
WZ 1030	14	-1,25	17,50	20,00	4,0	125	50	12	5	14	WZ 1030	32	-1,5	37,50	40,5	5,0	160	63	20	6	25
WZ 1030	15	-1,25	18,75	21,25	4,0	125	50	12	5	15	WZ 1030	32	-2	38,00	42,00	6,3	200	63	18	7	19
WZ 1030	16	-1,25	20,00	22,50	4,0	125	50	14	5	16	WZ 1030	38	-2,5	45,00	50,00	8,0	225	80	20	9	18
WZ 1030	17	-1,25	21,00	24,00	5,0	160	63	15	6	14	WZ 1030	43	-2,5	50,00	55,00	8,0	225	80	20	9	20
WZ 1030	18	-1,25	21,25	23,75	4,0	125	50	14	5	17	WZ 1030	44	-2	50,00	54,00	6,3	200	63	20	7	25
WZ 1030	19	-1,25	22,50	25,00	4,0	125	50	14	5	18	WZ 1030	48	-2,5	55,00	60,00	8,0	225	80	24	9	22
WZ 1030	20	-1,5	24,00	27,00	5,0	160	63	15	6	16	WZ 1030	50	-2	56,00	60,00	6,3	200	63	20	7	28
WZ 1030	22	-1,25	25,00	27,50	5,0	125	50	16	5	20	WZ 1030	54	-2	60,00	64,00	6,3	200	63	22	7	30
WZ 1030	22	-1,5	27,00	30,00	5,0	160	63	16	6	18	WZ 1030	56	-2,5	62,50	67,50	8,0	225	80	24	9	25
WZ 1030	25	-1,5	30,00	33,00	5,0	160	63	20	6	20	WZ 1030	68	-2,5	75,00	80,00	8,0	225	80	26	9	30
WZ 1030	29	-2	34,00	38,00	6,3	200	63	18	7	17											

# WZ 1200

Racks

Mat.: ~1.7225 ~1080 N/mm<sup>2</sup>

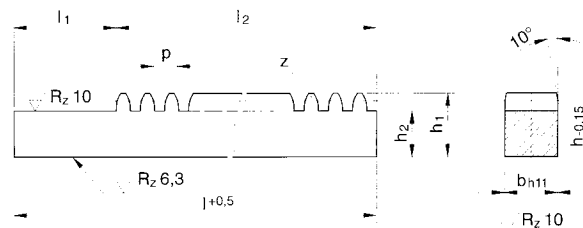

m = module  
p = pitch p= m x p (mm)

REF	b	l	m	h	h1	h2	l1	l2	z	REF	b	l	m	h	h1	h2	l1	l2	z
Wz 1200	18	-400	-1.25	16	17.25	14.4	39.4	361.1	92	Wz 1200	25	-630	-2.00	20	22.00	17.5	64.8	565.2	90
Wz 1200	18	-560	-1.25	16	17.25	14.4	41.6	518.4	132	Wz 1200	25	-800	-2.00	20	22.00	17.5	65.2	734.9	117
Wz 1200	18	-800	-1.25	16	17.25	14.4	42.3	757.7	193	Wz 1200	25	-1000	-2.00	20	22.00	17.5	64.1	935.9	149
Wz 1200	20	-500	-1.50	18	19.50	16.1	52.6	447.5	95	Wz 1200	28	-800	-2.50	25	27.50	21.8	77.7	722.3	92
Wz 1200	20	-630	-1.50	18	19.50	16.1	50.6	579.4	123	Wz 1200	28	-1000	-2.50	25	27.50	21.8	81.4	918.7	117
Wz 1200	20	-800	-1.50	18	19.50	16.1	51.0	749.1	159	Wz 1200	28	-1250	-2.50	25	27.50	21.8	80.0	1170.0	149





**8-impresion hot runner mold** : rotary movement of the coarse pitch nut through mold aperture.

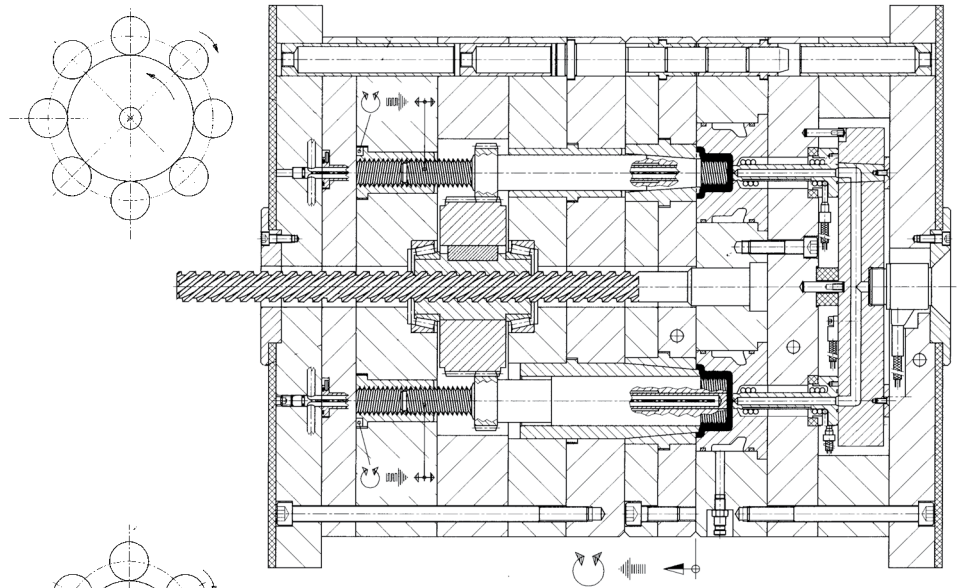

**6-impresion hot runner mold** : rotary movement of the coarse pitch axle through machine hydraulic system.

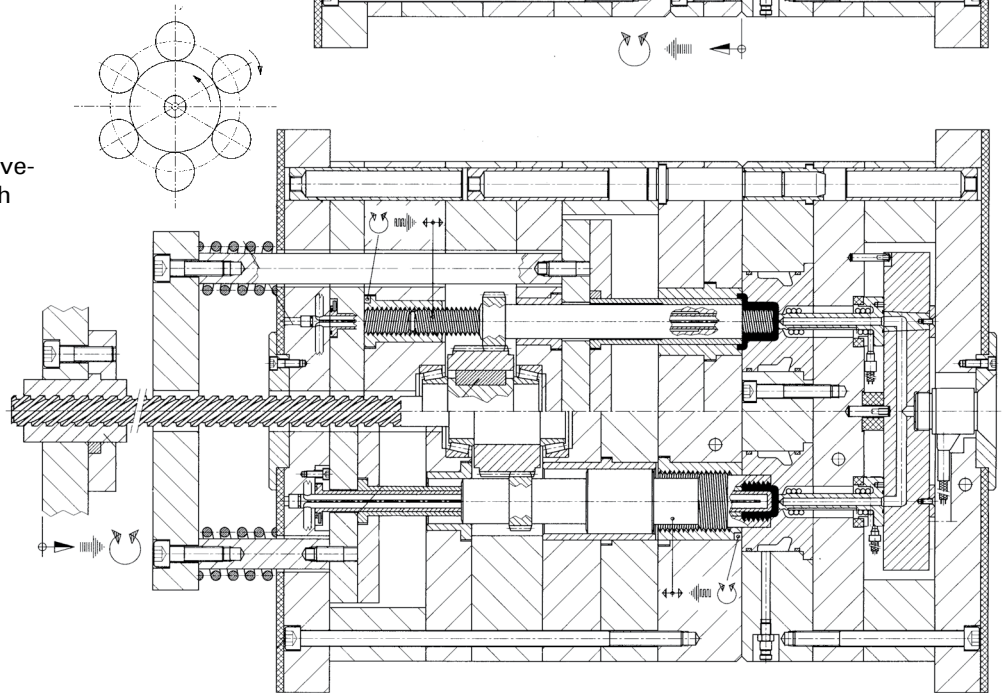

**2x4-impresion hot runner stack molds** : rotary movement of the coarse pitch double axle (1) through mold aperture (H) for movement and fixing of the middle block (H/2). Rotary movement of coarse pitch double axle (2) through activation of the machine ejector for movement of the fixed-side ejector plates via the moving side ejector plates.

